

Londinium: port of Roman London



Gustav Milne

CITIZAN MOLA



Timber-faced wharves



ENTRE MARES
TRANS-ROSIAN
31/10/18 - 31/10/2018

The port of Roman London
Gustav Milne, CITIZAN Project Leader, Museum of London Archaeology

Entre Mares | EEHAR

Horrea

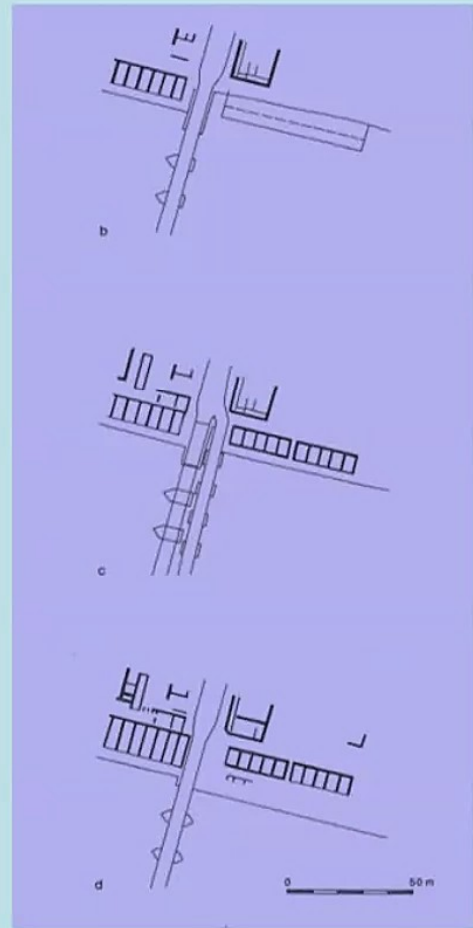

The port of Roman London
Gostar Mihor, CITIZAN Project Leader, Museum of London Archaeology

Entre Mares | EEHAR



ENTRE MARES
FRANÇOIS JORDAN
3 4 1 8 - 33 - 302 001 70

The port of Roman London
Gustav Mihor, CITIZAN Project Leader, Museum of London Archaeology

Entre Mares | EEHAR

Bridge

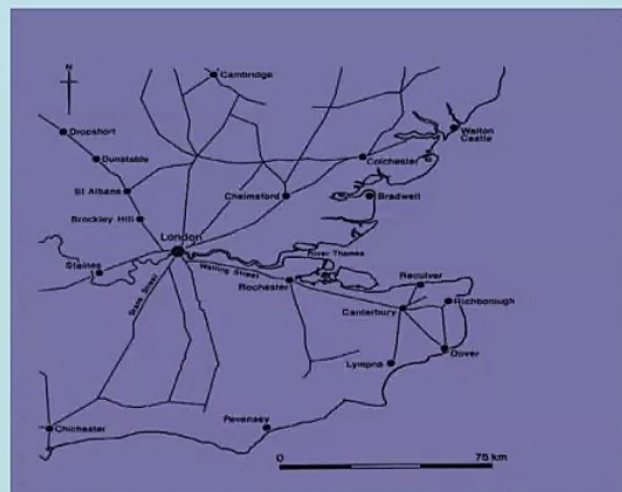

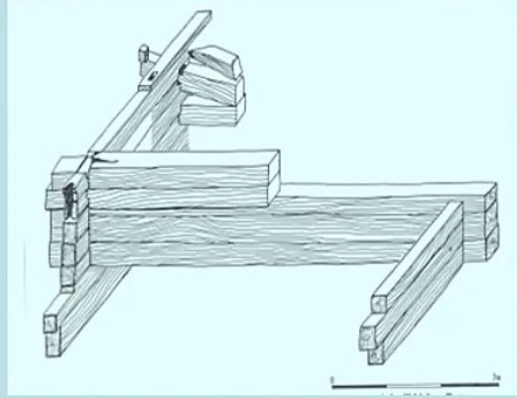
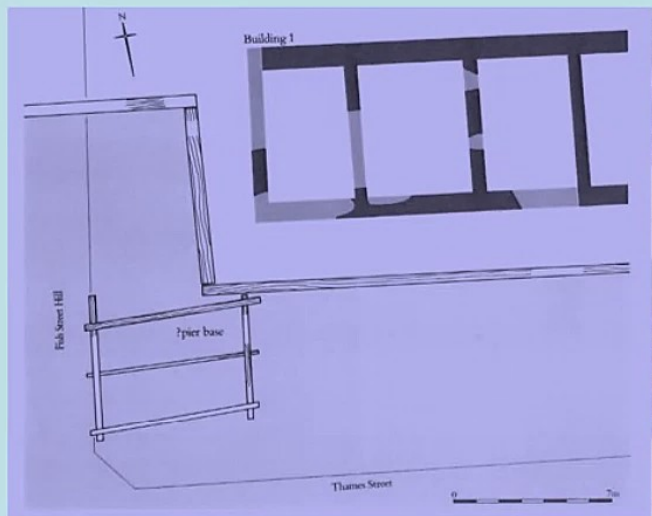

ENTRE MARES
FRANÇOIS GUYARD
31/10/18 - 31/10/21 2018

The port of Roman London

Gustav Milne, CITIZAN Project Leader, Museum of London Archaeology

Entre Mares | EEHAR

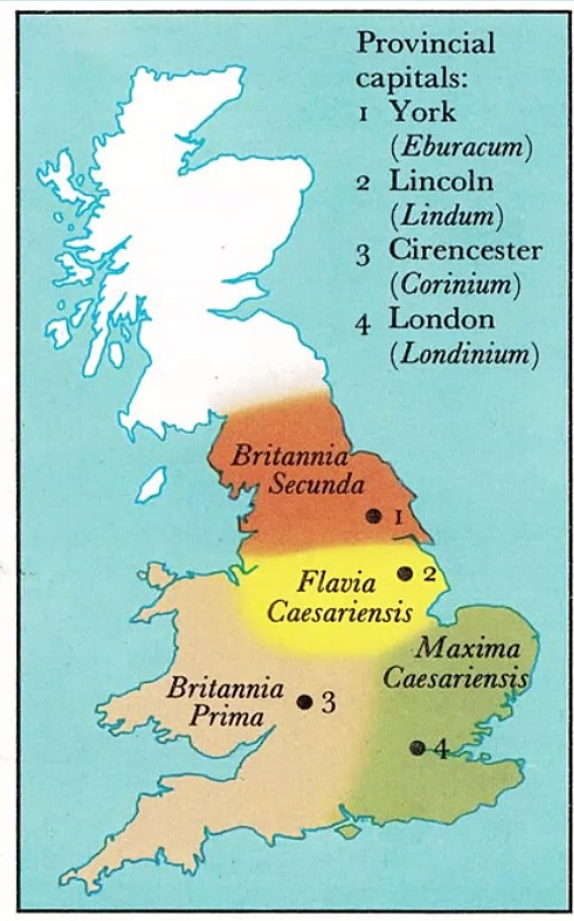
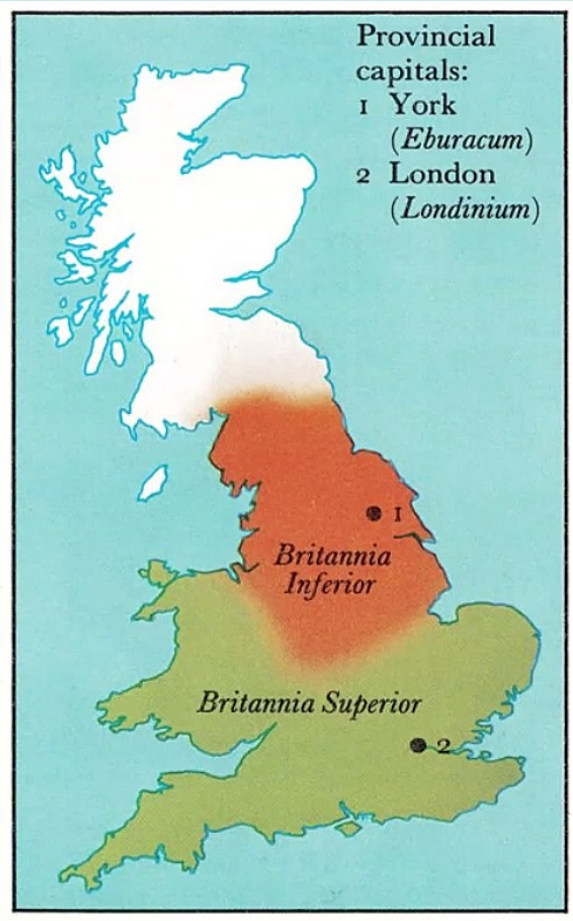

ENTRE MARES
RESEARCH PARTNERS
31/10/18 - 31/10/2018

The port of Roman London
Gustav Milne, CITIZAN Project Leader, Museum of London Archaeology

Entre Mares | EEHAR

River levels drop:

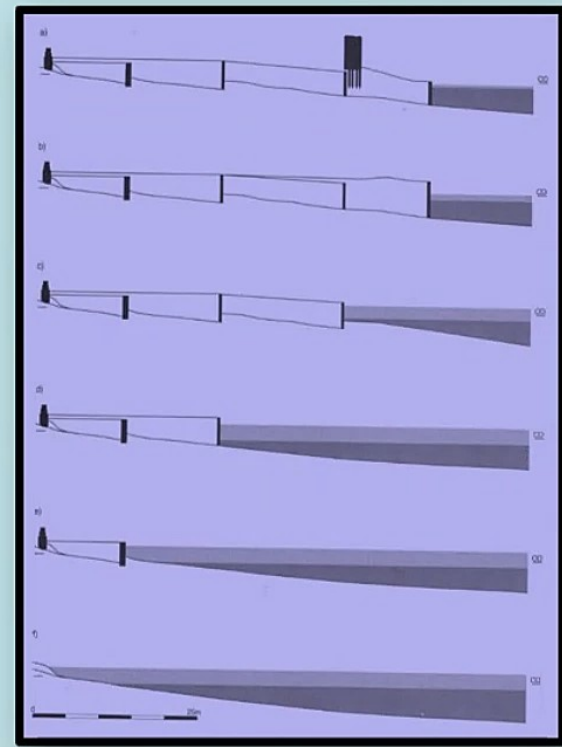

Thames no longer tidal at in late Roman period:
Londinium no longer major port



Chronological development

- **C1st & C2nd**
Bridge built &
harbour expansion



- **Late C3rd**
Harbour works
dismantled:
riverside wall built



- **C5th**
Londnium abandoned

