

Mounichia Harbour, artistic reconstruction Shiphsheds 1-2

Artist: Yiannis Nakas (2010)

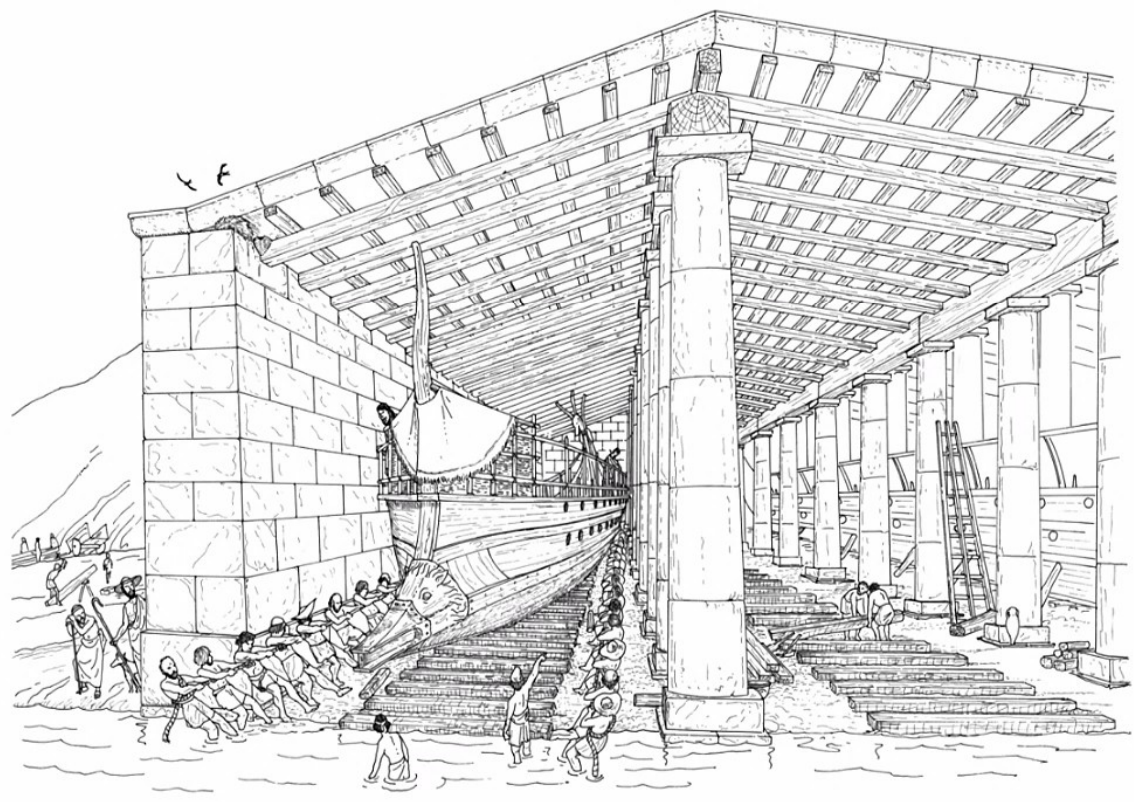

Björn Loven



Entre Mares



Zea Harbour, artistic reconstruction of the Group 1 Shipsheds

Artist: Yiannis Nakas (2019)



Bjørn Loven



Zea Harbour, reconstruction of the Group 1 Shiphsheds

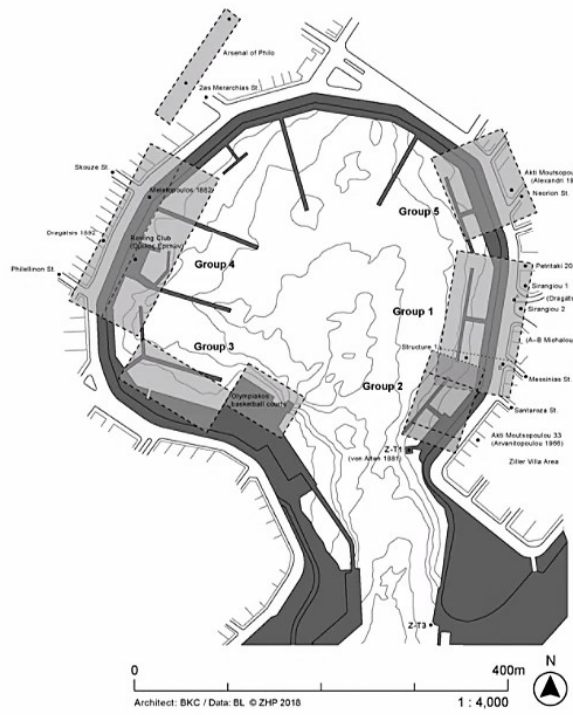

Bjørn Loven

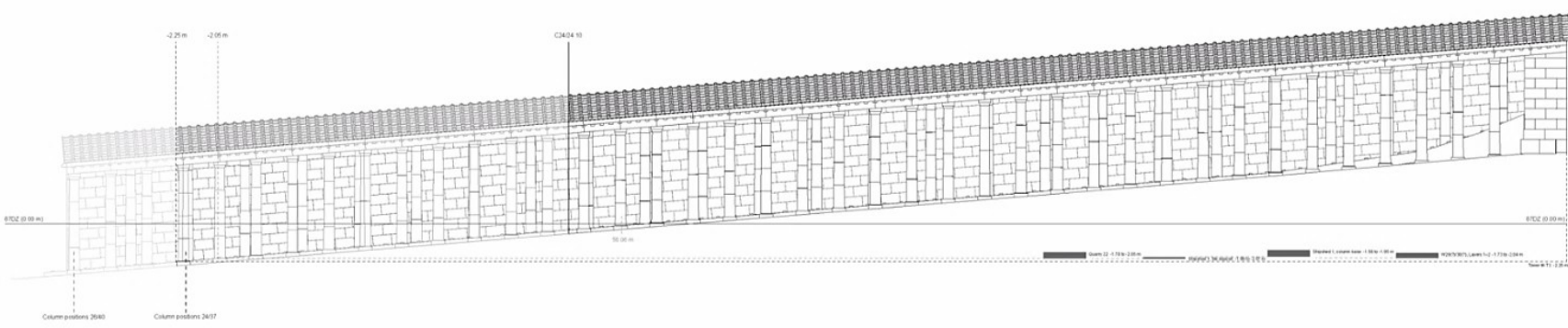

Zea Harbour, reconstruction & artistic reconstructions of the Phase 3 Shipheds

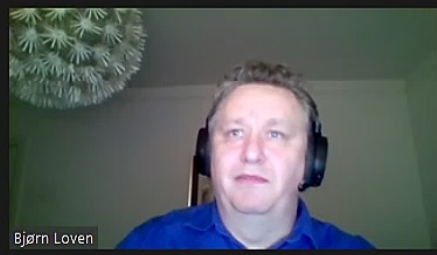
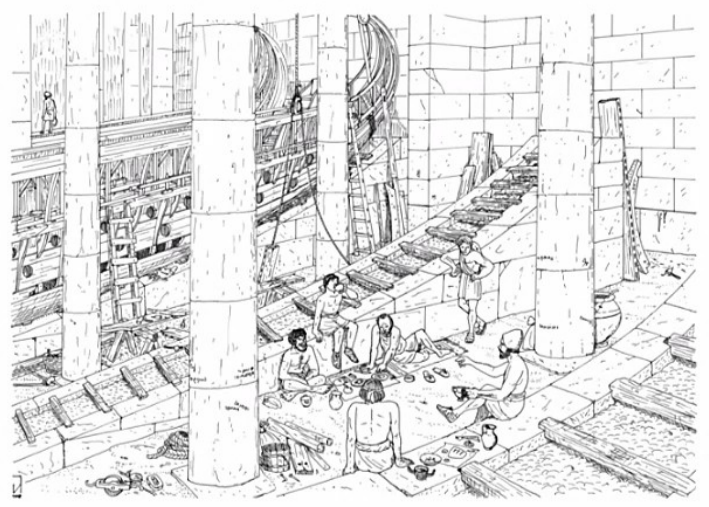
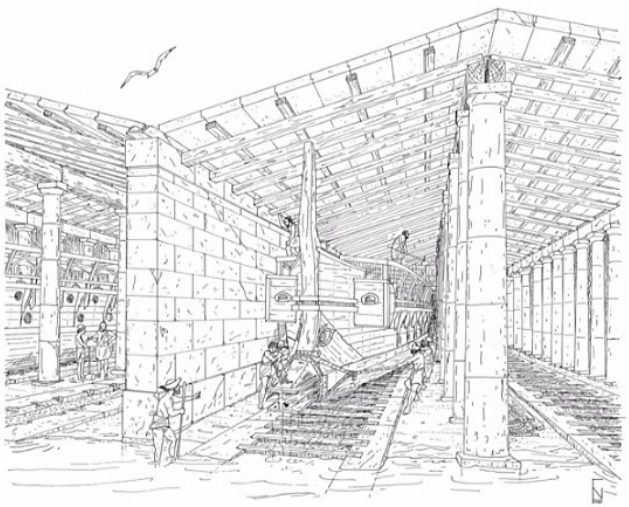

Zea Harbour, artistic reconstruction of the wide unroofed slipways

Artist: Yiannis Makos (2021)



Bjørn Loven

Zea Harbour, reconstruction of the Group 2 Slipways

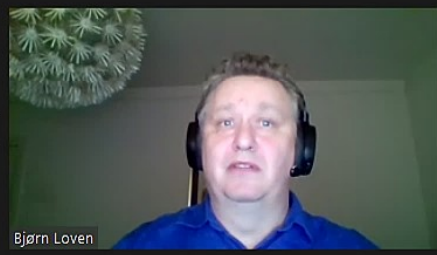
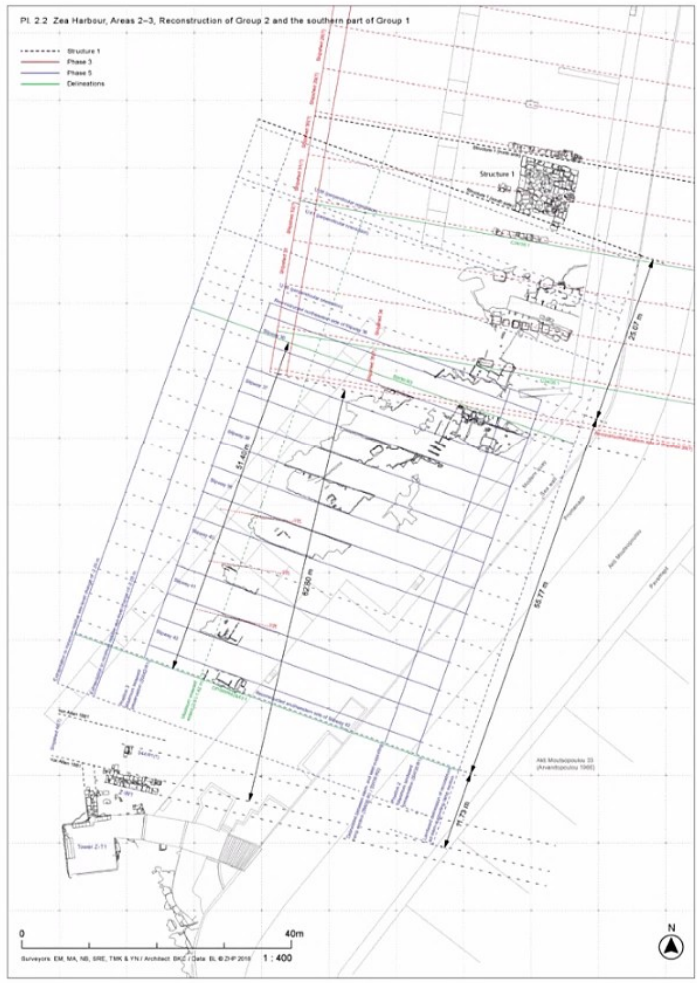
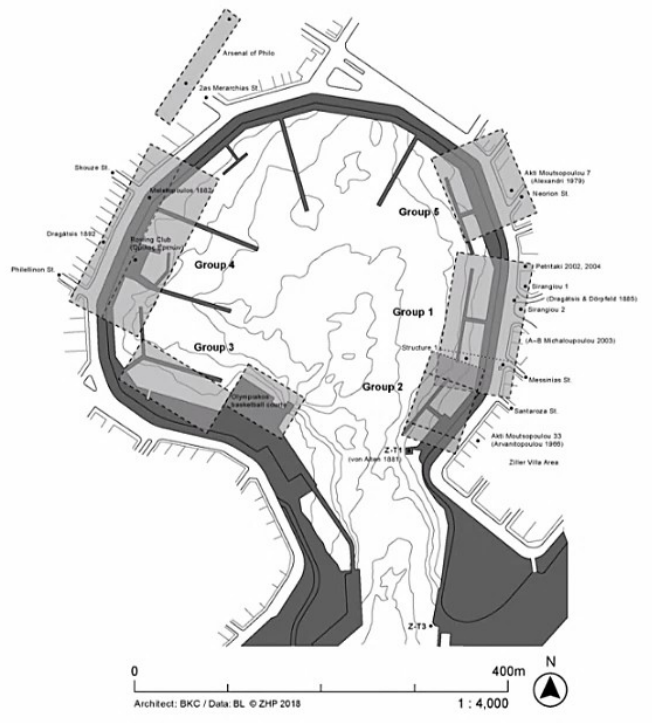

Zea Harbour, Structure 1

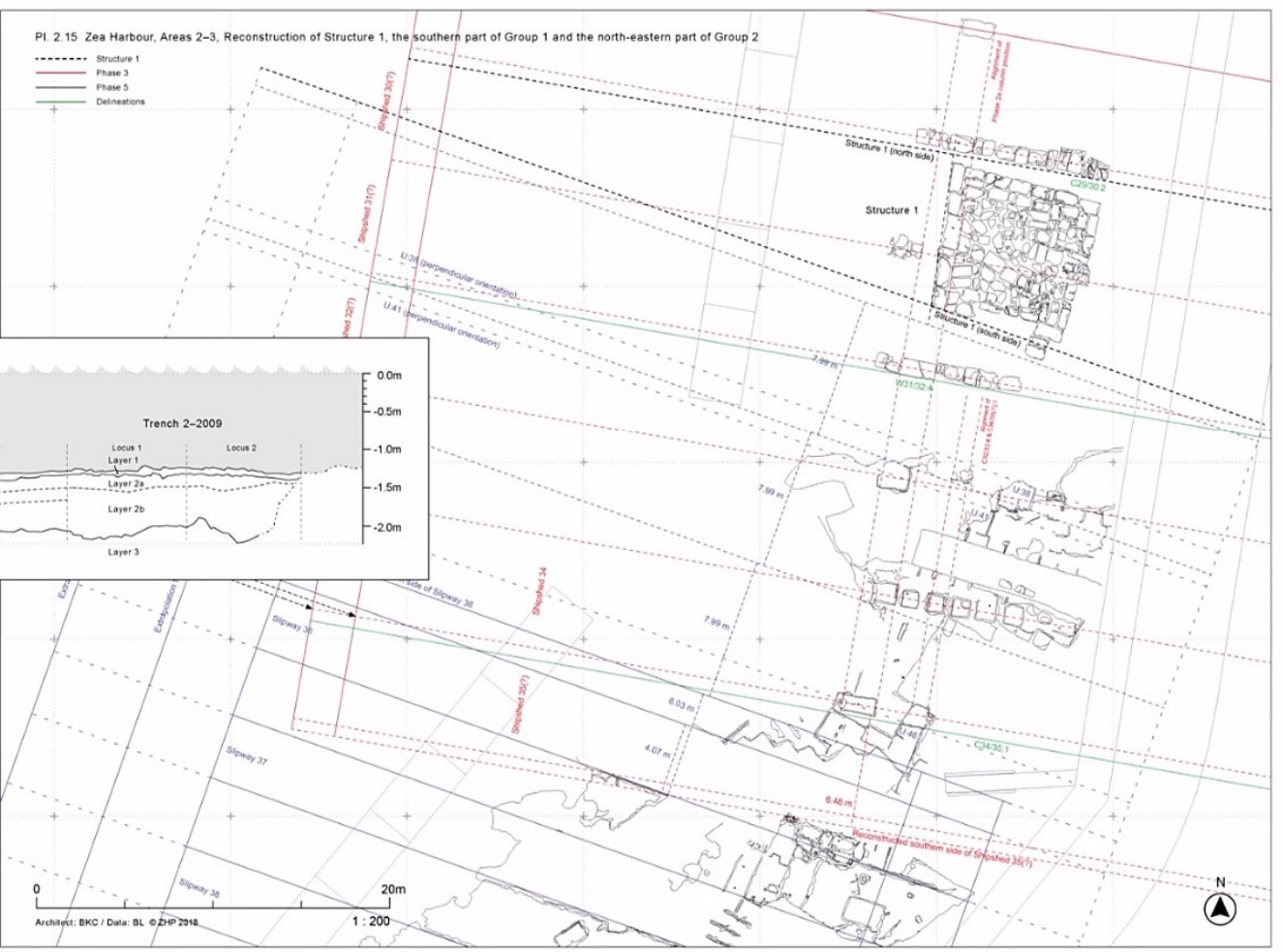

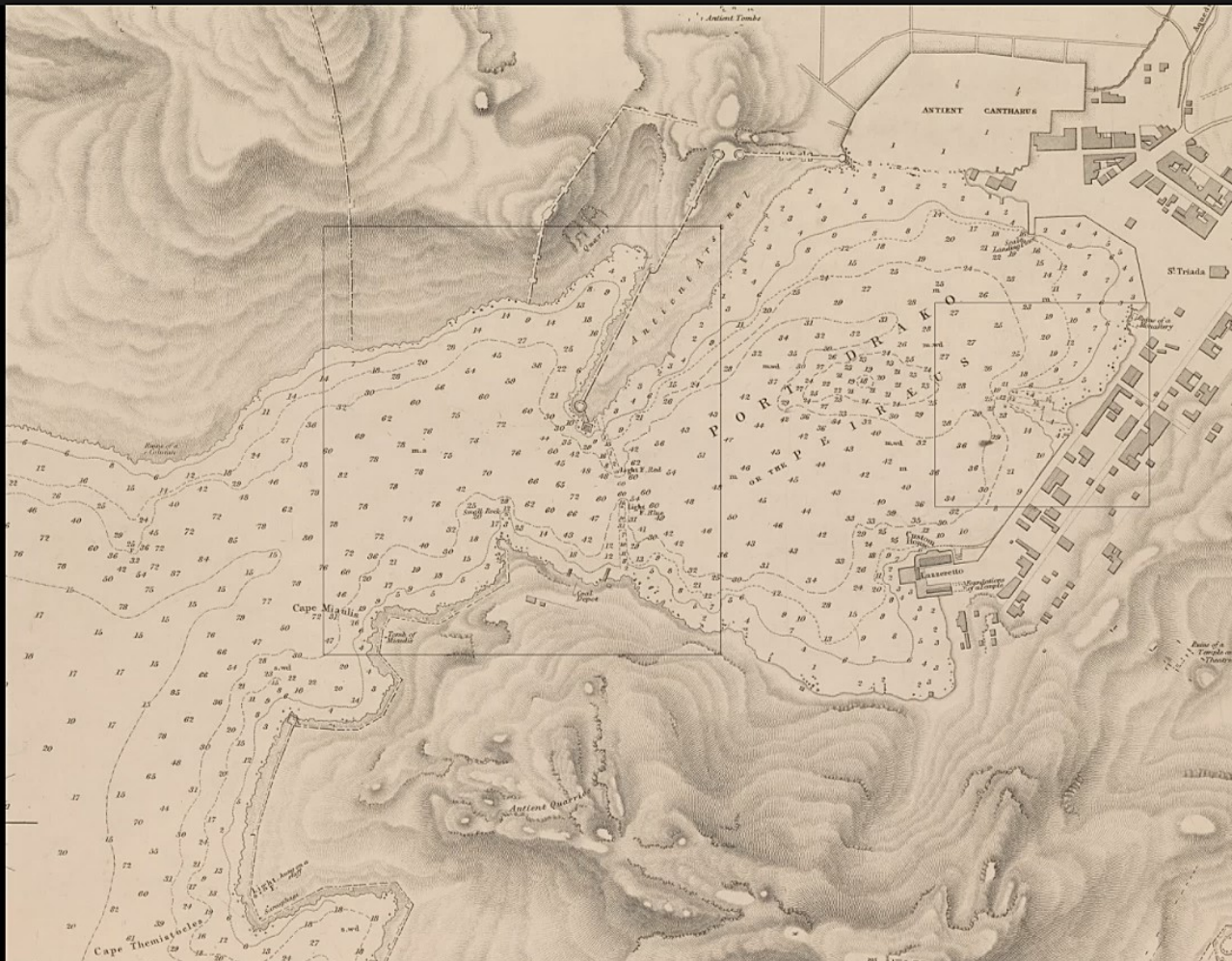

Bjørn Loven

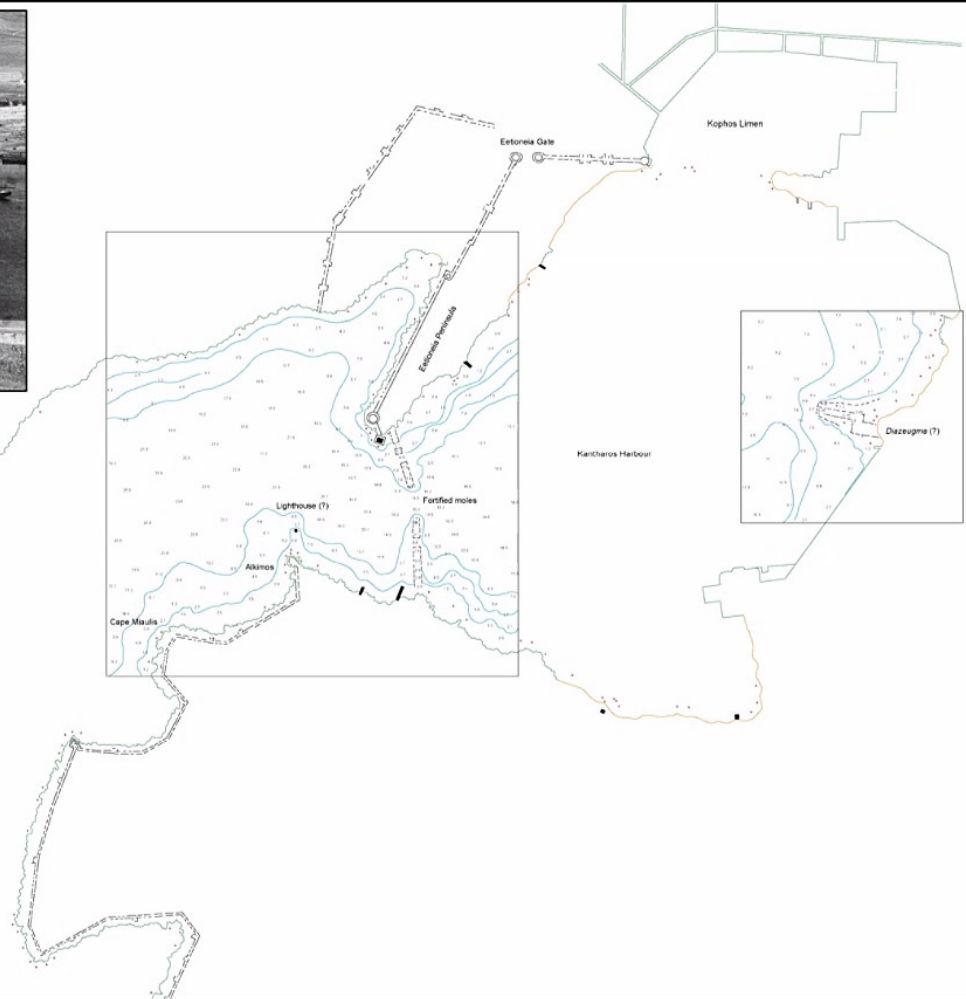

Bjørn Loven

Kantharos Harbour, artistic reconstruction of the harbour fortifications

Artist: Yiannis Nakas (2021)

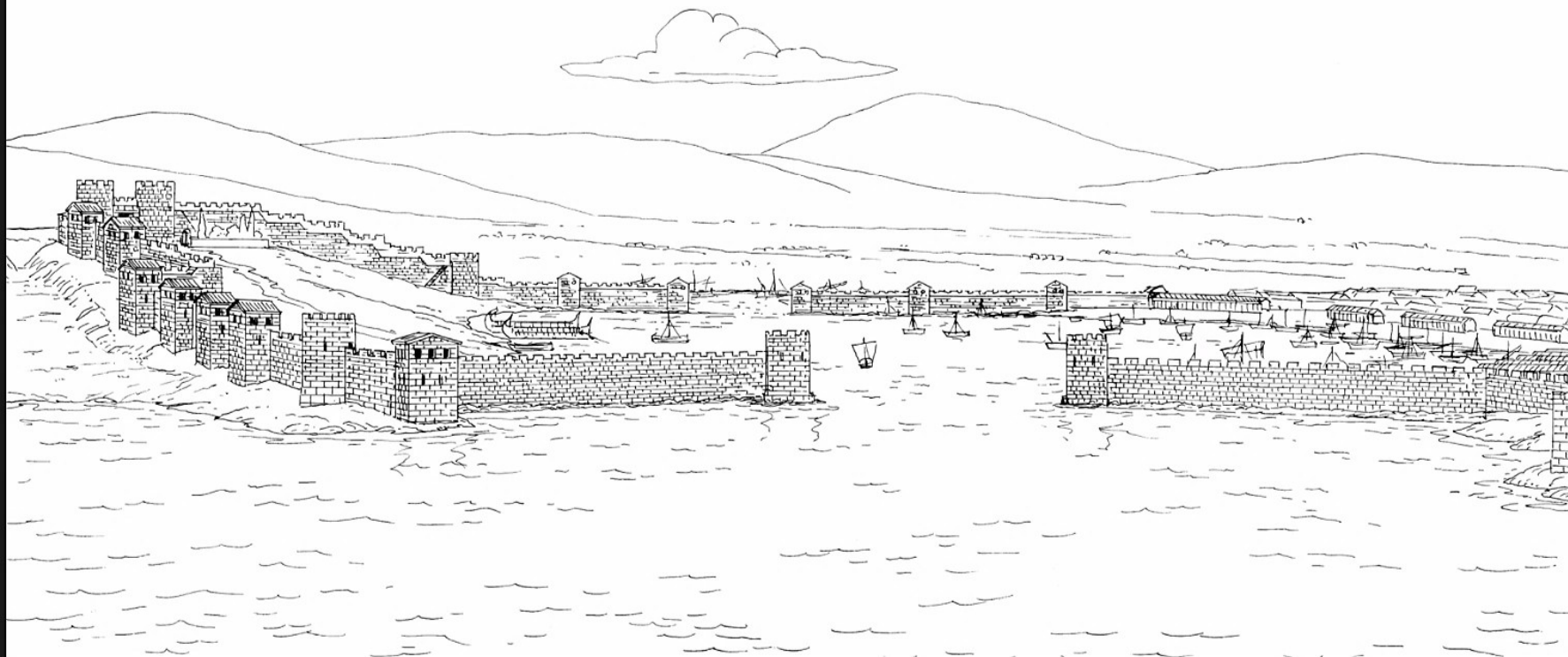

Bjørn Loven

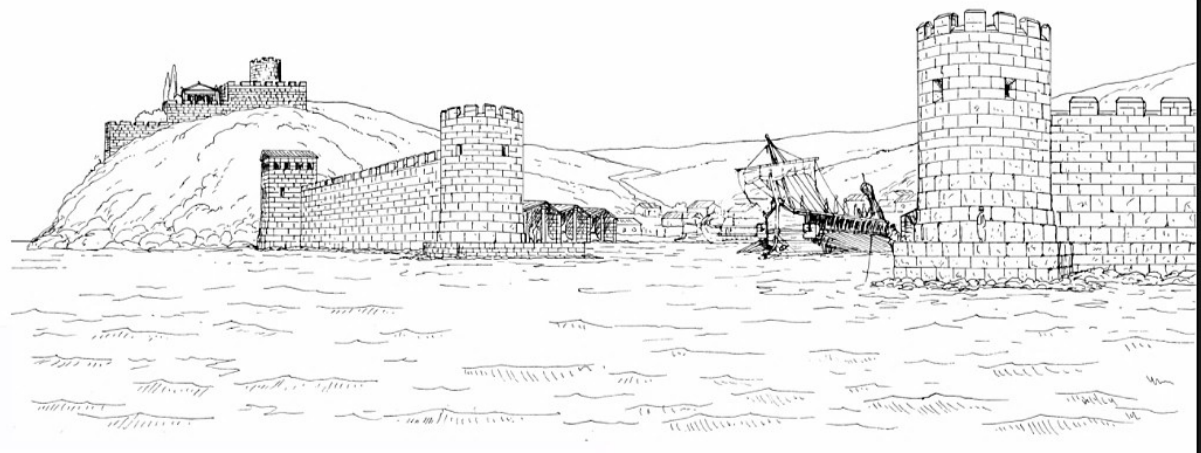

Artistic reconstruction of Mounichia Harbour

Artist: Yiannis Nakas (2021)

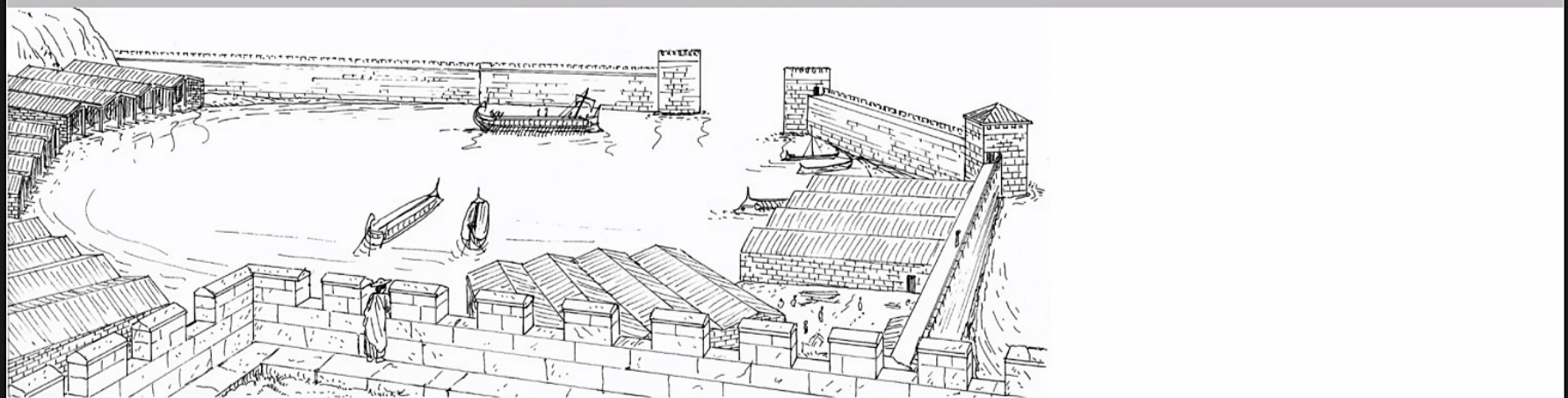

Bjørn Loven

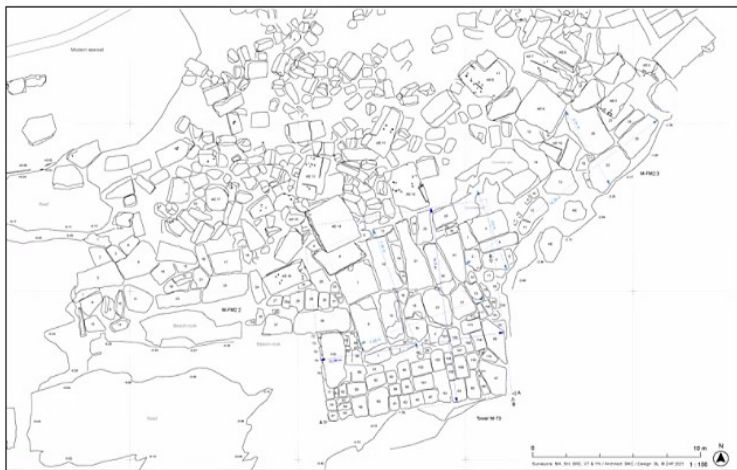
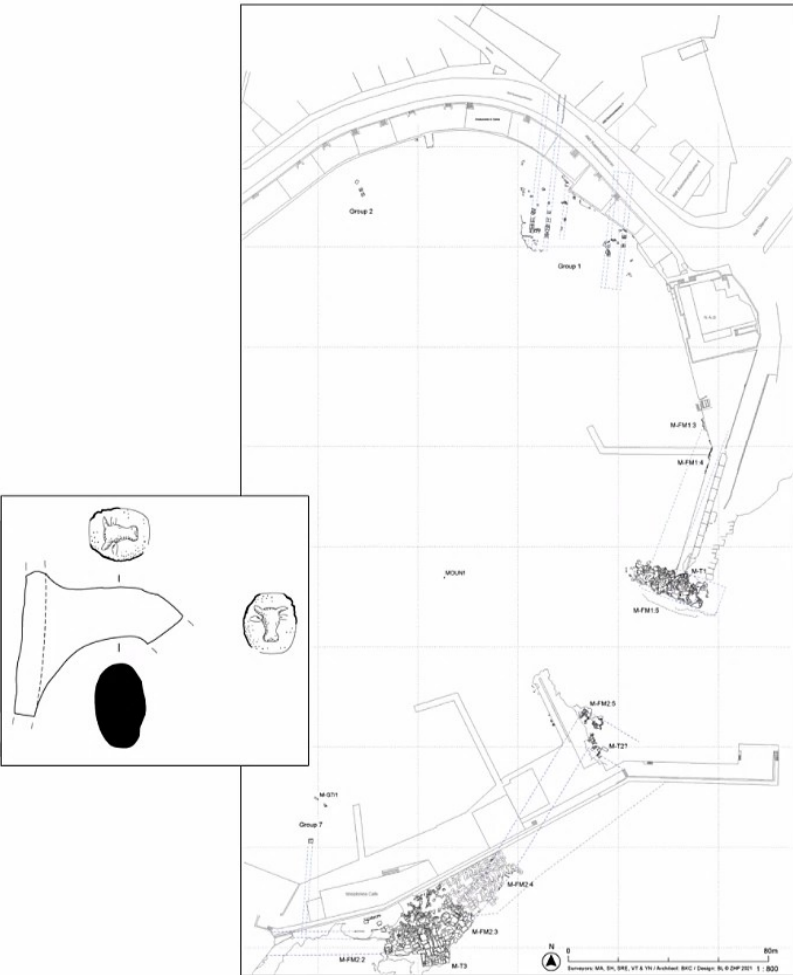

Bjørn Loven

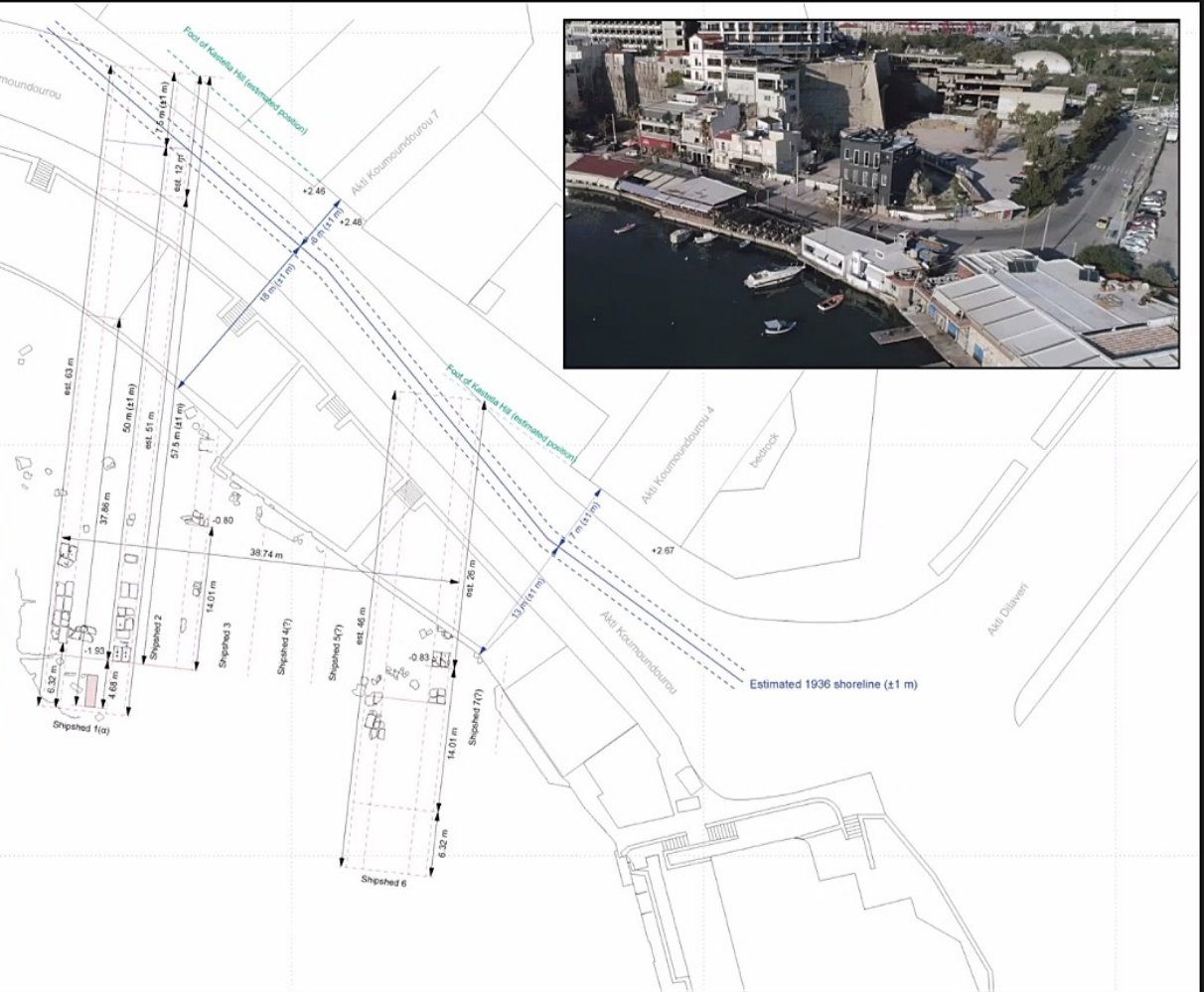

Bjørn Loven

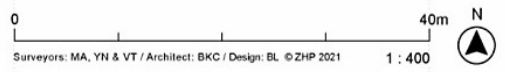

Surveyors: MA, YN & VT / Architect: BKC / Design: BL © ZHP 2021

1 : 400

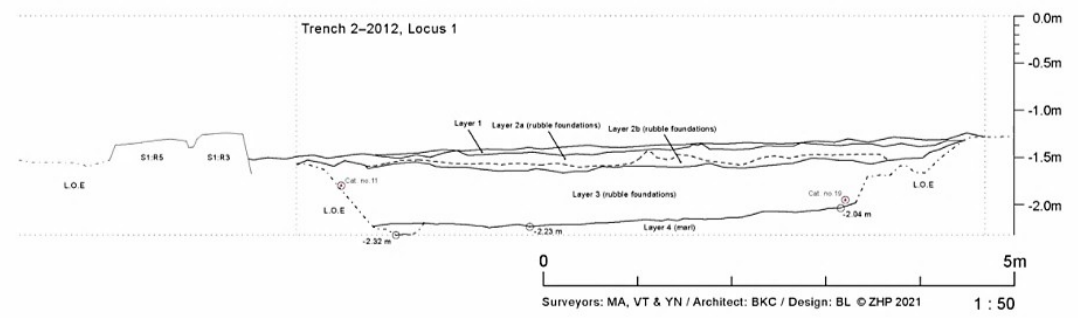
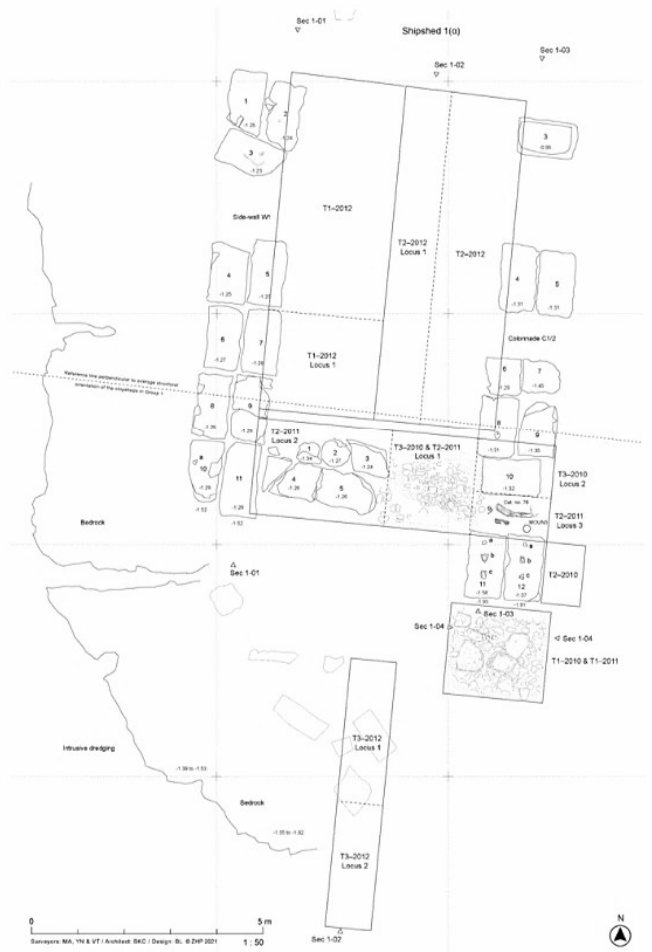

Ramp of Shipshed 1, Trench 2-2012, Layer 3
(terminus post quem 500-480 BC)

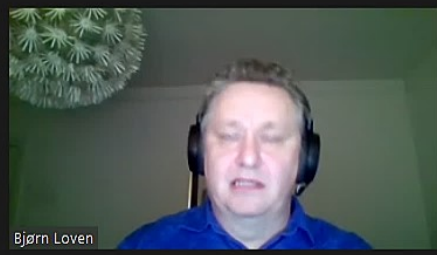
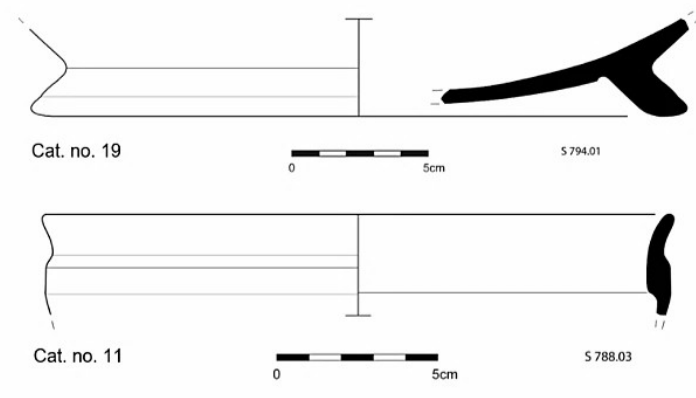

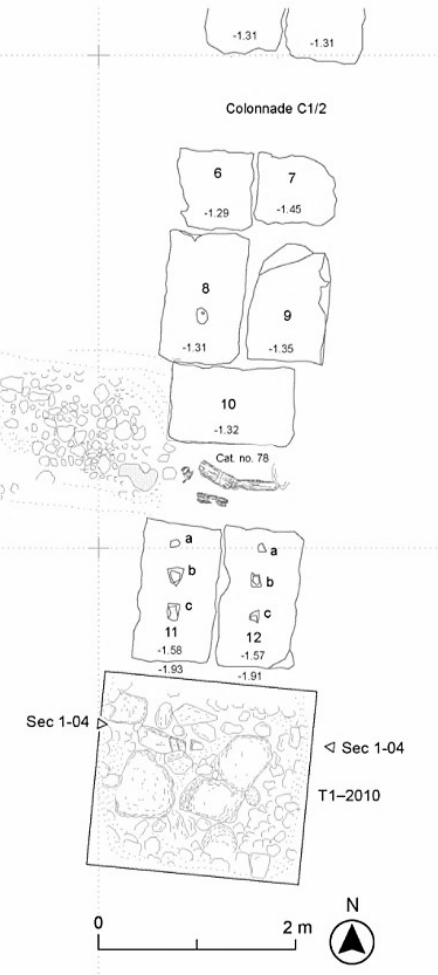

Colonnade dividing Shipsheds 1 and 2, Trench 1–2010, Layer 2 (*terminus post quem* 520–480 BC)

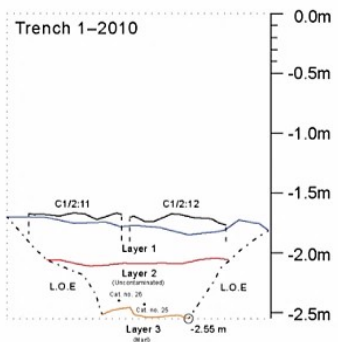

Colonnade dividing Shipsheds 1 and 2, cross section 1-04

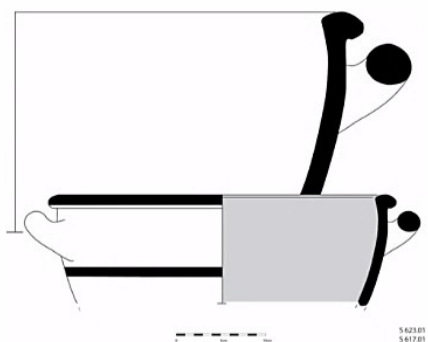

Cat. nos. 25–26



Bjørn Loven